

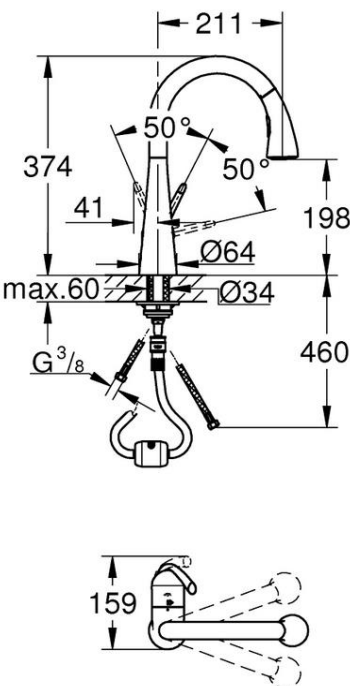









PROJECT		REF		REV	ITEM CODE	
LOCATION		DATE			PAGE	

SANITARY WARE SPECIFICATION SHEET

<p>Item Descriptions</p> <p>Dimensions</p> <p>Model</p> <p>Finish / Material</p> <p>Country of origin</p> <p>Manufacturer</p> <p>Supplier</p> <p>Contact Tel/Fax</p> <p>E-mail</p> <p>Website</p>	<p>GROHE (Germany) "Zedra" Chrome plated 3/8" single-lever sink mixer with pull-out dual spray; nominated flow rate 4.6 L/min in WELS Grade 1; Registration No. TM 19-0039</p> <p>L211 x W159 x H374 mm</p> <p>32294001</p> <p>Chrome Plated</p> <p>Germany</p> <p>GROHE Limited</p> <p>Acme Sanitary Ware Co. Ltd Mr. Eric Wong/ Mr. Don Yuen (852) 2388-7171 / (852) 2710-8012 acme@acmesanitary.com.hk www.acmesanitary.com.hk</p>	<p>Illustration/ Drawing</p>   <div style="display: flex; flex-direction: column; align-items: flex-end;">       </div> <p>"Zedra" Single-lever sink mixer</p> <ul style="list-style-type: none"> • monobloc installation • GROHE StarLight finish • GROHE SilkMove 46 mm ceramic cartridge • GROHE Zero separated inner water ways - lead and nickel free • pull-out dual spray control - switches between regular flow and spray • diverter: mousseur/shower jet • automatic return to mousseur • adjustable flow rate limiter • swivel tubular spout • swivel area 360° • integrated non-return valve • protected against backflow • flexible connection hoses • rapid installation system <p style="text-align: center;"> 32294SD1</p> <p>Colour options:</p> <ul style="list-style-type: none"> ● 001 StarLight Chrome ● SD1 SuperSteel
---	---	--

Note: [grohe zedra 32294001](https://www.youtube.com/watch?v=8z4do_Vfqgw) https://www.youtube.com/watch?v=8z4do_Vfqgw
[32294 Grohe Zedra](https://www.youtube.com/watch?v=bmXfb4p9pzg) <https://www.youtube.com/watch?v=bmXfb4p9pzg>

* All information of the above is for the reference only. No prior notice is made if any changes.



PROJECT		REF		REV	ITEM CODE	
LOCATION		DATE			PAGE	

SANITARY WARE SPECIFICATION SHEET

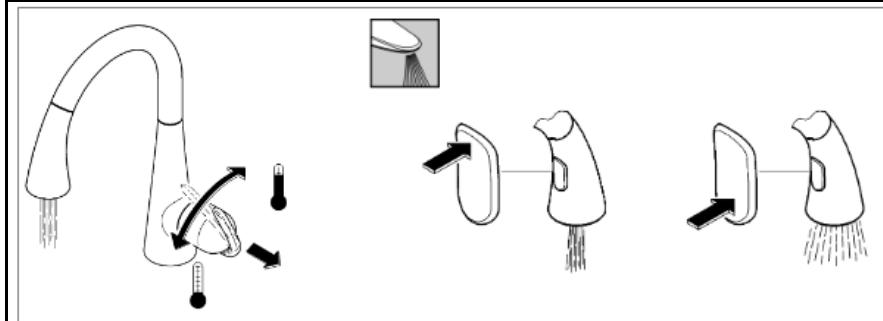

Pull-out comfort shower head
with spray jet and shower jet



Pull-out comfort shower head
with spray jet and shower jet

Pull-out comfort shower head
with spray jet and shower jet



SPARE PARTS

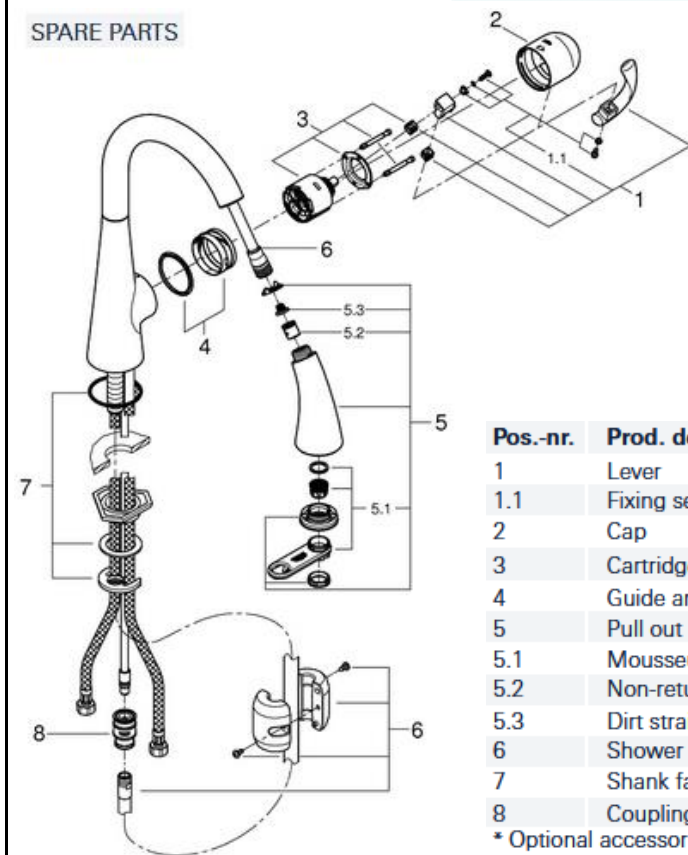

Swivel range 360°
for effortless convenience

Pos.-nr.	Prod. description	Order-nr.
1	Lever	46654000
1.1	Fixing set	46310000
2	Cap	46655000
3	Cartridge	46048000
4	Guide and slide ring	46632V00
5	Pull out spray	46875NC0
5.1	Mousseur	46711000
5.2	Non-return valve	08565000
5.3	Dirt strainer	0676800M
6	Shower hose	48293000
7	Shank fastening assembly	46345000
8	Coupling piece	46338000

* Optional accessories



Note:

* All information of the above is for the reference only. No prior notice is made if any changes.



自願參與用水效益標籤計劃 - 水龍頭
Voluntary Water Efficiency Labelling Scheme - Water Taps



茲證明
This is to certify that

將下列水龍頭在本計劃內註冊：
has registered the following water tap under this scheme :

牌子 / Brand	:	GROHE
型號 / Model	:	32294XX1 + 64647040
種類 / Type	:	Mixing
原產地 / Country or Region Origin	:	Portugal

在用水效益標籤上展示的標誌 <i>Symbolic Presentation on the Water Efficiency Label</i>	:		滴水點 <i>Water droplet(s)</i>
用水效益級別 <i>Water Efficiency Grade</i>	:	1	
耗水量 <i>Water Consumption</i>	:	4.6	公升/分鐘 <i>litres/minute</i>

簽發日期: 18 January 2019
Date of Issue:

 水務署
Water Supplies Department



水務署署長(陳仲勤代行)
for Director of Water Supplies



水務署
Water Supplies Department

總部 Headquarters

灣仔告士打道七號入境事務大樓 48 樓

Immigration Tower, 7 Gloucester Road, Wan Chai, Hong Kong



SD 3321/18 Pt.1 T/J(1173)

電話

Tel.

傳真

Fax.

: 2824 0578

20 November 2018



Approval of "GROHE" Sink Mixer (General Acceptance No. C20180788)

Your letter ref. WRC/1989 dated 15 October 2018 refers.

Having considered the test report ref. J23455A issued on 10 October 2018 by Nutek Systems (HK) Ltd. and WRAS certificate, this Authority accepts that the fitting described below complies with, and its use when correctly installed does not contravene, the Waterworks Ordinance and Regulations.

Name of Manufacturer: Grohe AG

Country of Origin: Portugal

Brand: Grohe

Details of Fitting:

3/8" Single lever sink mixer supplied with:

- 1) 1 no of Neoperl GmbH – CRG, black coloured, extruded high density polyethylene hose approved by UK's WRAS under certificate no. 1803511
- 2) 2 nos of Neoperl GmbH – Neoflex SPX DN6 G3/8" flexible connection hoses approved by UK's WRAS under certificate no. 1506306



香港環境保護署
Hong Kong Health and Environmental Commission



10+ caringorganisation
A caring organisation for the environment
SUSTAINABLE

Model: 32294XX1
(where the digits "XX" denote the code of colour)

Body Markings: 

Expiry Date: 31 March 2023 (for mixer + hose (1))
30 June 2020 (for hose (2))

This Authority hereby permits the use of the above fitting in fresh water plumbing systems subject to full adherence to Waterworks installation requirements. In particular, you are required to draw your customers' attention to the following requirement-

"The cold water supply to the fitting shall be drawn from the same source that supplies the hot water apparatus so as to provide a balanced pressure and to obviate the risk of scalding in the event of a restriction or failure in the water supply."

A condition of this acceptance is that the fitting to be installed shall be replicas of the sample as certified by the testing agent mentioned above and without modifications. This acceptance may be withdrawn at any time if the standard of the fitting installed fails to meet that of the approved sample or if the fitting is found to be unsuitable for use in fresh water plumbing systems.

This acceptance is only applicable to the main body of the fitting, unless other specified.

For the use of the fitting in any project, the General Acceptance Number of this letter must be quoted as a means of identification of acceptance of the fitting by this Authority.

Should you have any enquiries, please contact our Engineer Mr. Terry KUNG at tel. no. 3583 4086.

Yours faithfully,



(CHAN Chung-kun)

for Director of Water Supplies

Encl.

c.c. WSD 3321/1/82] - without catalogue
ME/MC] - with soft copy only